



# TP-PCC

## Instruction Sheet

### Program Copy Card

#### 1 WARNING

-  Always read this manual before using the TP-PCC.
-  TP-PCC doesn't support plug and play function. Please turn off power before plugging in TP02G or TP04G.
-  The voltage for TP-PCC is supplied from MPU extension slot. Please confirm TP-PCC plugged direction when connecting to MPU extension slot to avoid serious damage.

#### 2 INTRODUCTION

##### Model Explanation

TP - PCC

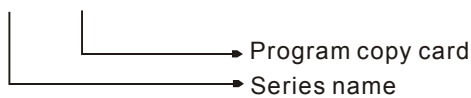

##### Serial Number Explanation

TP-PCC 1 T 3 18 002

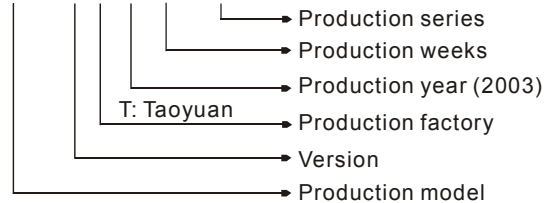

#### 3 ELECTRICAL SPECIFICATIONS

| Item                                      | Model Name | TP-PCC                                |
|---|------------|---------------------------------------|
| Data Reserved Life / Times for Writing In |            | 20 years / one hundred thousand times |
| Operation Temperature                     |            | 0°C~55°C                              |
| Weight / Dimension                        |            | 3g / 50.85×19.8×10 mm                 |

#### 4 PROGRAM COPY CARD FUNCTIONS

##### Compatible firmware version: TP04G (V1.04 and above) / TP02G (V1.00 and above)

It is used to copy the whole HMI environment settings and application programs to another HMI rapidly. It can save much time and manpower. The operation is in the following.

PCC: Program Copy Card

TP: TP Series

|   | TP→PCC (Copy HMI program to PCC)   | PCC→TP (Copy program in PCC to HMI)  |
|---|--|--|
| 1 | Turn the switch on the PCC to TP→PCC   | Turn the switch on the PCC to PCC→TP   |
| 2 | Insert the PCC into the extension slot of TP                                       | Insert the PCC into the extension slot of TP                                       |
| 3 | Input the power to TP  | Input the power to TP  |
| 4 | Please turn off power and then remove when it displays "remove PCC" on the screen. | Please turn off power and then remove when it displays "remove PCC" on the screen. |

| TP→PCC (Copy HMI program to PCC)   | PCC→TP (Copy program in PCC to HMI)  |
|--|--|
| <p>◆ If the model type of TP does not correspond with the model type of program of PCC.<br/><b>(TP04G program and TP02G program can't be used each other)</b><br/>TP will display:</p> <div data-bbox="310 327 769 443" style="border: 1px solid black; padding: 5px;">           TP series and PCC is different<br/>           Press Enter to Confirm<br/>           TP series→PCC<br/>           Press Esc to Exit         </div>  | <p>◆ If there is no program in PCC.<br/>TP will display:</p> <div data-bbox="932 247 1408 306" style="border: 1px solid black; padding: 5px;">           The PCC is Empty<br/>           PCC → TP series is illegal         </div> <p>◆ If the model type of TP does not correspond with the model type of program of PCC.</p> <div data-bbox="932 373 1408 457" style="border: 1px solid black; padding: 5px;">           TP series and PCC is different<br/>           Please Remove the PCC<br/>           and Reboot         </div>  |
| <p>◆ If the model type of TP corresponds with the model type of program of PCC.<br/>TP will display:</p> <div data-bbox="310 575 769 659" style="border: 1px solid black; padding: 5px;">           Press Enter to Confirm<br/>           TP series→PCC<br/>           Press Esc to Exit         </div> <p>Press &lt;Enter&gt; to confirm to copy.</p> <p>◆ When executing "writing in" (data is transmitting and indication LED of RS-485 will light)<br/>TP will display:</p> <div data-bbox="310 789 769 848" style="border: 1px solid black; padding: 5px;">           TP series →PCC<br/>           Please wait!         </div> | <p>◆ If the model type of TP corresponds with the model type of program of PCC.<br/>TP will display:</p> <div data-bbox="932 575 1408 659" style="border: 1px solid black; padding: 5px;">           Press Enter to Confirm<br/>           TP series→PCC<br/>           Press Esc to Exit         </div> <p>Press &lt;Enter&gt; to confirm to copy.</p> <p>◆ When executing "writing in" (data is transmitting and indication LED of RS-485 will light)<br/>TP will display:</p> <div data-bbox="932 789 1408 848" style="border: 1px solid black; padding: 5px;">           PCC →TP series<br/>           Please wait!         </div> |
| <p>◆ When completing transmitting, TP will display:</p> <div data-bbox="310 919 769 953" style="border: 1px solid black; padding: 5px;">           Please Remove the PCC and Reboot         </div> <p>◆ Please turn the power off and remove PCC from TP. At this time, all program and system settings have copied to PCC.</p>  | <p>◆ When completing transmitting, TP will display:</p> <div data-bbox="932 919 1408 953" style="border: 1px solid black; padding: 5px;">           Please Remove the PCC and Reboot         </div> <p>◆ Please turn the power off and remove PCC from TP. At this time, all program and system settings have copied to PCC.</p>   |

**5** DIMENSION AND INSTALLATION

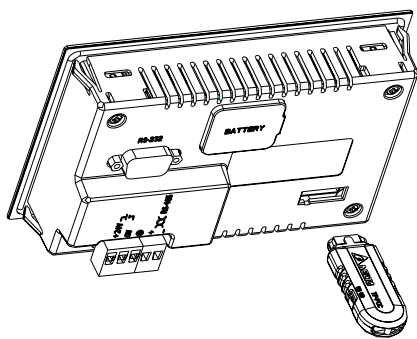
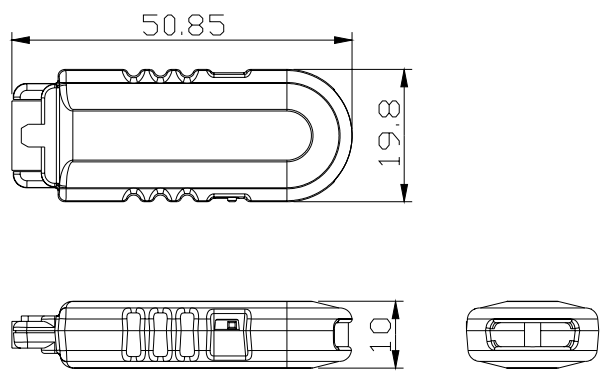

(Unit: mm)